

Mobile Cart for TVs & Interactive Touch Panels 32" - 65"

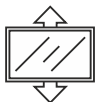

Max weight
60 kg
132.3 lbs



Height adjustment
700 - 1200 mm
27.6" - 47.2"



Tilt
90°



VESA
200 x 200 ~
600 x 400 mm

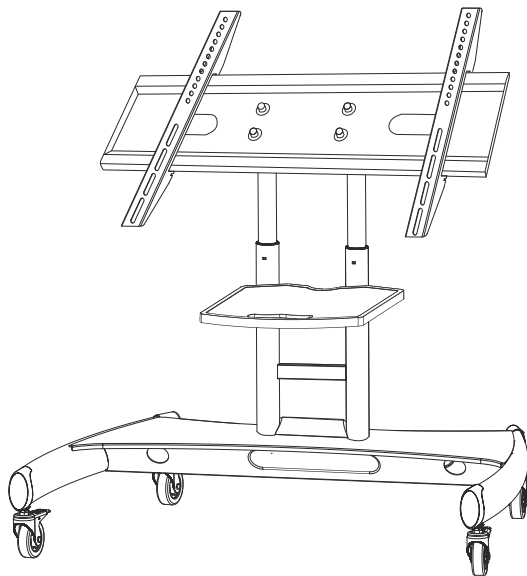

EN

USER GUIDE



Thank you for choosing us!

We hope you are happy with your purchase. If you enjoy our product, please leave your review.

If you have any questions or issues, contact us anytime and we will help you as soon as possible:

USA: sale@onkron.us / +13159682278

Europe: sale@onkron.de / +494029996807

Russia: support@onkron.ru / +78007772176

Read the entire manual before you start assembly and installation. If you have any questions about the assembly and operation of the bracket, please contact our service department.

CAUTION

Using the product with devices that exceed allowed weight limit, improper assembly and installation, including overtightening mounting screws, may lead to failure of your devices and the product itself, and also cause personal injuries.

- Product must be assembled as specified in the following assembly instructions. Improper installation may result in damage or serious personal injuries.
- Safety gear and proper tools must be used. This product should be installed only by professionals.
- Make sure that working surface will safely support combined weight of the equipment and all attached hardware and components.
- Use mounting screws provided in the kit and **DO NOT OVERTIGHTEN** any screws during assembly of the product.
- This product contains small items that may cause choking if swallowed. Keep these items away from children.
- Using the product improperly could lead to product failure and personal injuries.
- Before mounting a screen make sure it meets all requirements of the product. Pay attention to VESA patterns, supported screen weight and diagonal.
- Mounting an unsupported screen could lead to product failure and personal injuries.

IMPORTANT

Make sure you have received all parts according to the component checklist **BEFORE** the installation. If any parts are missing or faulty, contact your local distributor for a replacement.

MAINTENANCE

Check your product is safe to use at regular intervals (at least every three month).

WARRANTY

Not under mandatory certification. Unlimited lifespan. **5 YEARS WARRANTY.**

Assembly Kit:

Firstly unpack all components and make sure that you have all necessary parts. In case you have any missing parts contact with our service department. Check the list:

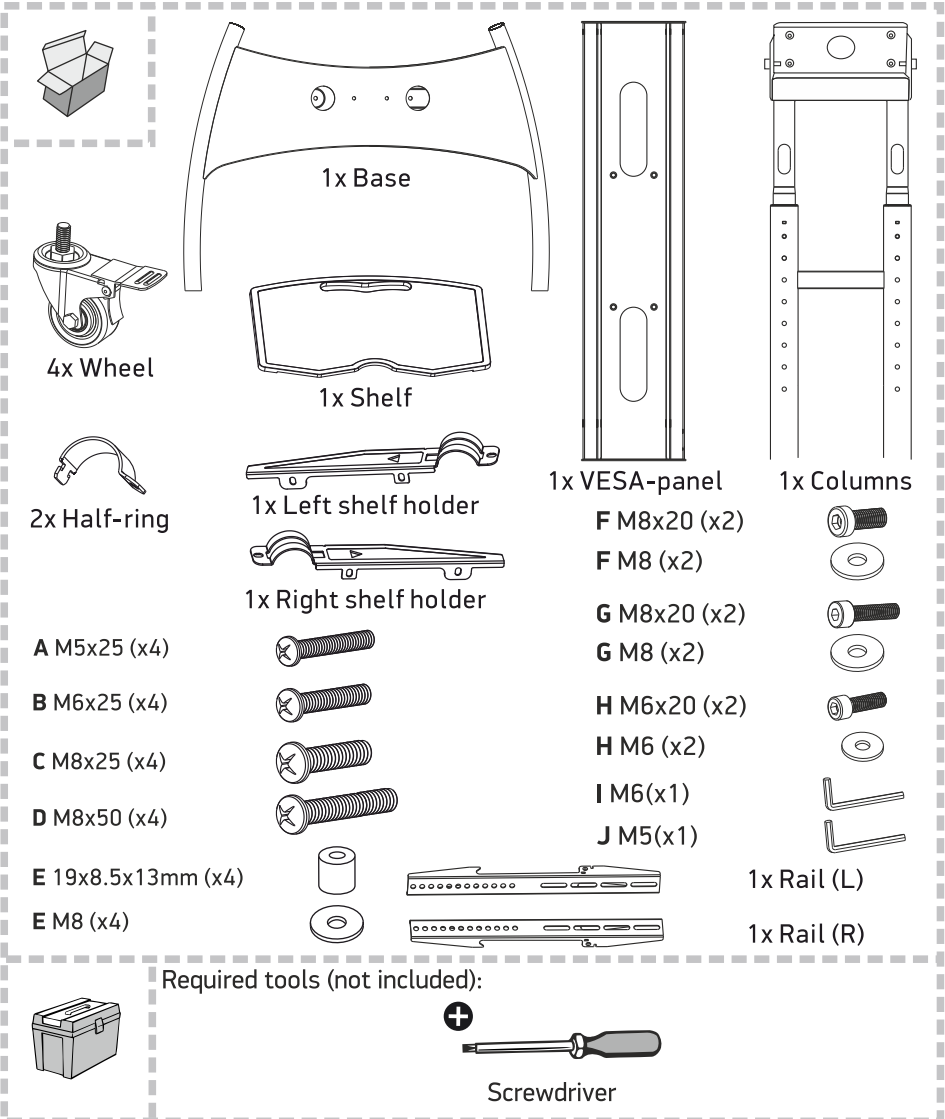

1. Base assembly:

- Put the package on the floor
- Put the base of the stand on it upside down.

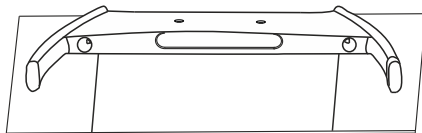

- Lock all the wheels, as shown.

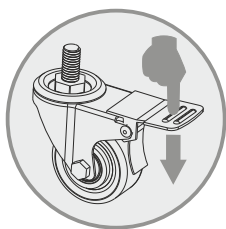

- Put the base on the wheels with the back side to you. Remove the package from the floor.

- Twist the wheels into the base.

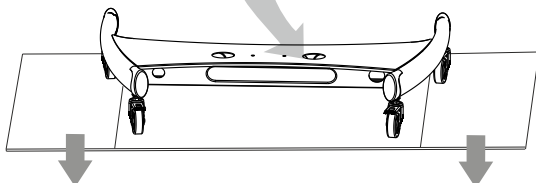
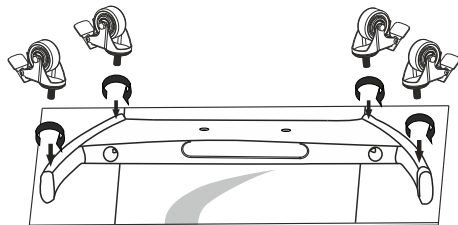

2. Height adjustment of the columns:

- Unscrew safety bolts from the columns using key (I).
- Set desirable height of the columns.
- Screw safety bolts in, using key (I).

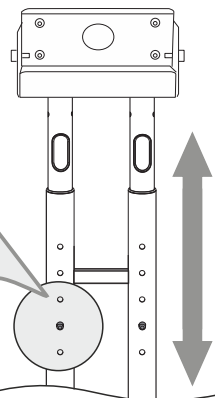
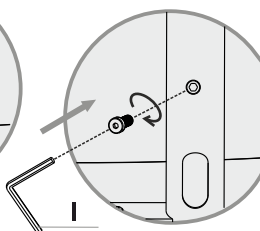
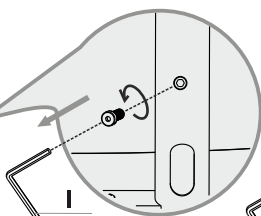
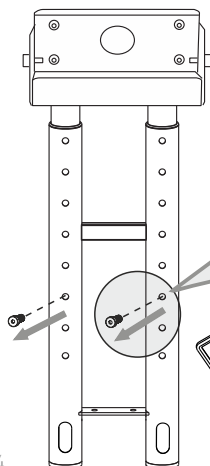

3. Installation of the columns to the base:

- Insert columns into the base. Cable management holes must be from the back of the stand. Look at the picture.

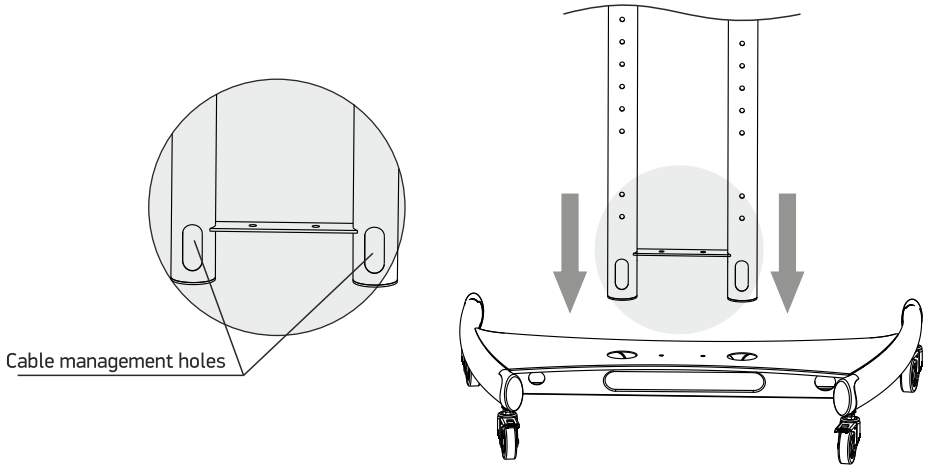

- Use key (I) to attach the columns to the base with bolts and washers (F) from above.

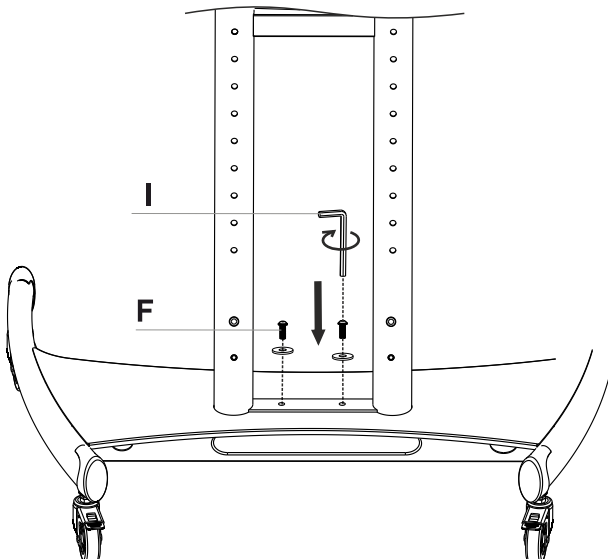

- Use key (I) to screw bolts and washers (G) from beneath of the base. Look at the picture.
- Make sure that all bolts are secure fixed and the whole construction is stable.
- Put plastic cover as shown on the picture.

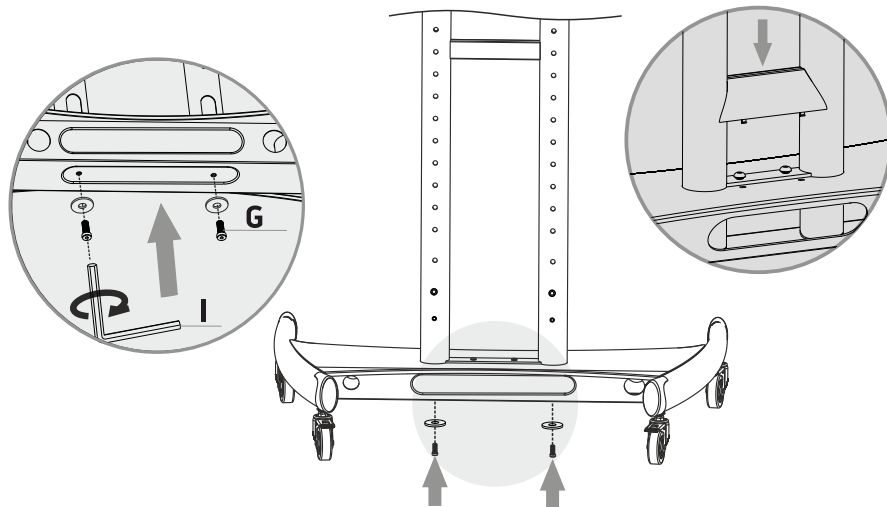

4. VESA-panel installation:

- Install VESA-panel to the columns of the base, using bolts that already screwed in the tilting panel. Use key (I). Set desirable angle of the panel within the range 0° - 90° .

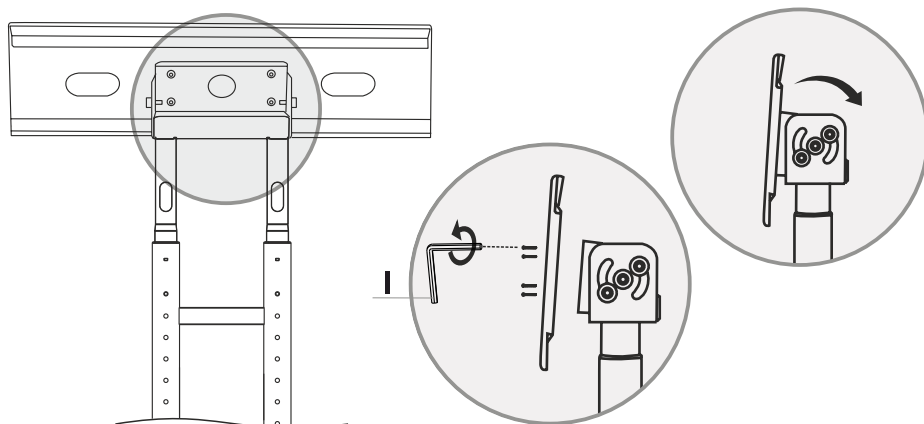

5. Installation of the rails to the touch panel / TV:

- Unscrew bolts and take off safety latches from the rails (L) and (R).

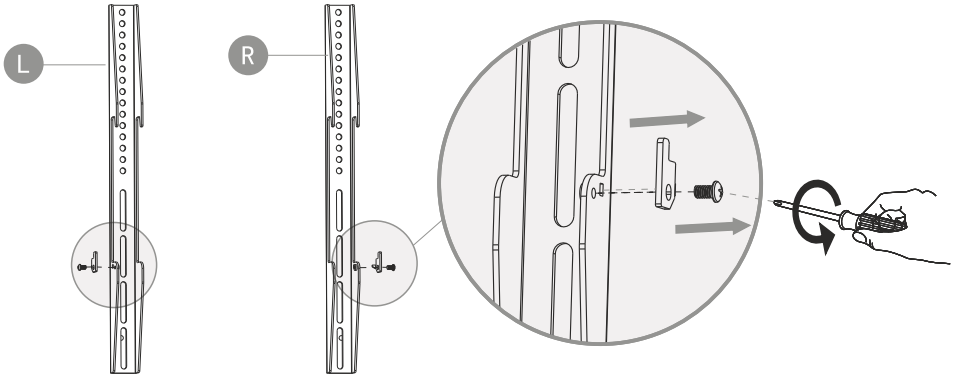

- Pick suitable bolts A/B/C/D from the kit to mount your touch panel / TV.
- Put both rails to the back of your touch panel / TV. Match holes of your screen's VESA and the rails. Screw bolts in your touch panel / TV, using plastic spacers and washers (E) between screen and the rails.
- Additional way of installation: plastic spacers and washers (E) can be used between bolts A/B/C/D and the rails.

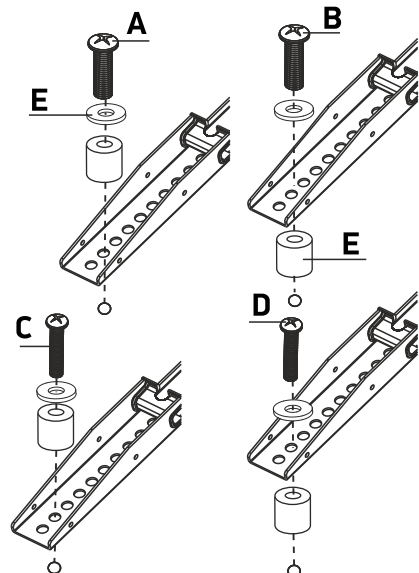
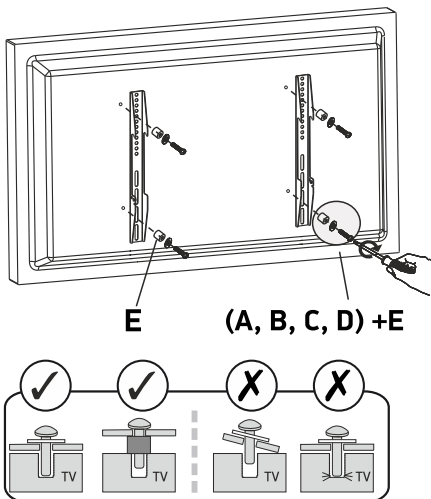

6. Possible VESA patterns and their sizes:

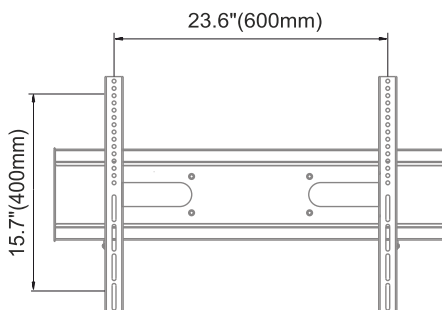
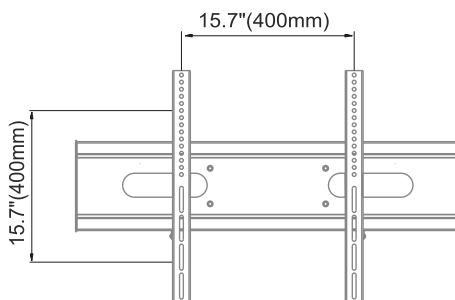
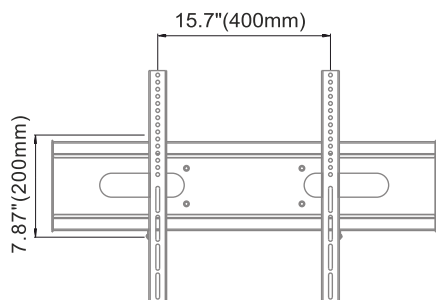
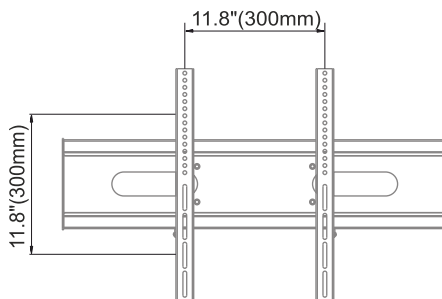
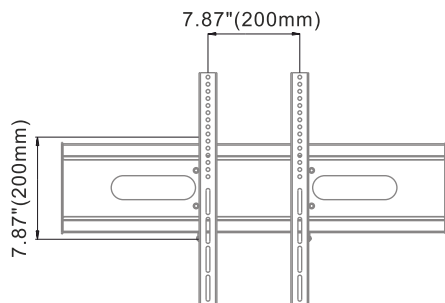

7. Touch panel / TV mounting:

- Hang your touch panel / TV with installed rails onto VESA-panel of the stand.



To avoid injuries it is highly recommended to perform adjustment and installation with the help of another person.

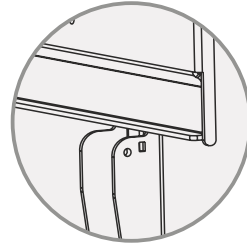
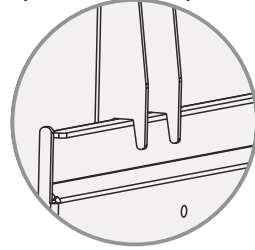
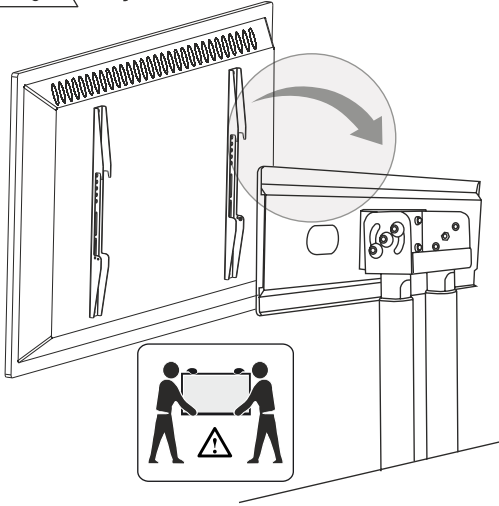

- Align the screen to the center of the VESA-panel.
- Install safety latches and tighten bolts to fix the position of your touch panel / TV.

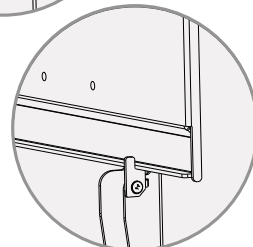
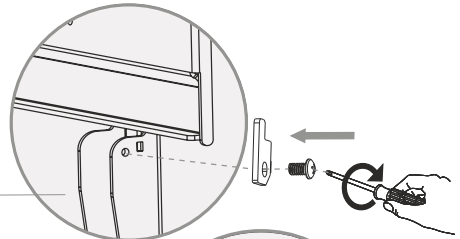
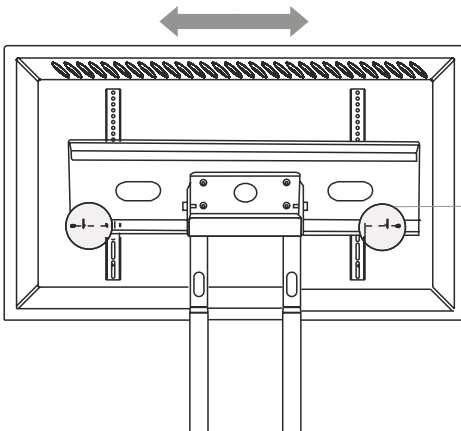

8. Assembly and installation of the shelf:

- Unscrew four bolts from the shelf. Use a screwdriver.
- Install shelf holders by starting the bolts (1) and (3). Look at the picture.

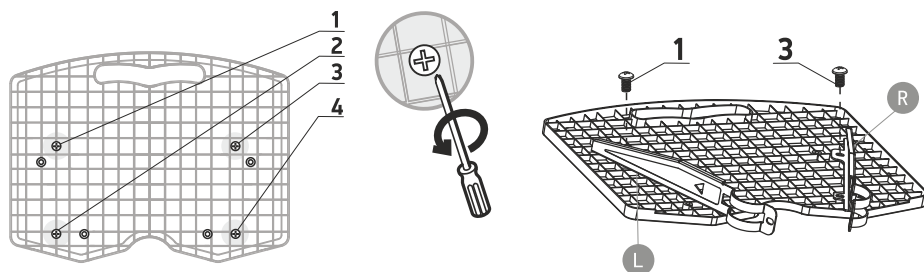

- Insert half-ring into the shelf holder. Turn the half-ring to match its position with the shelf-holder.
- Repeat the previous step with the second shelf-holder.

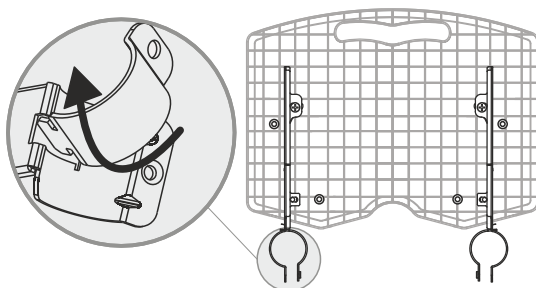

- Tighten bolts (1) and (3) using a screwdriver.

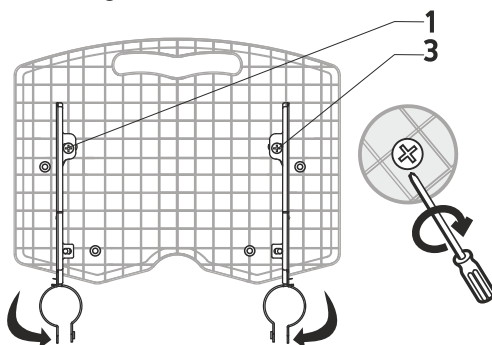

- Set desirable height for the shelf on the columns and fix half-rings and shelf-holders with bolts and washers (H). Use key (J). Make sure that all bolts are securely fixed.

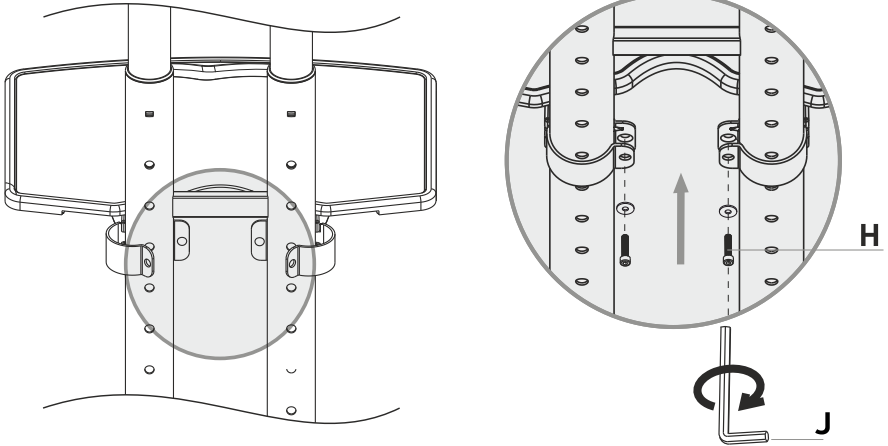

- Tighten bolts (2) and (4) using a screwdriver.

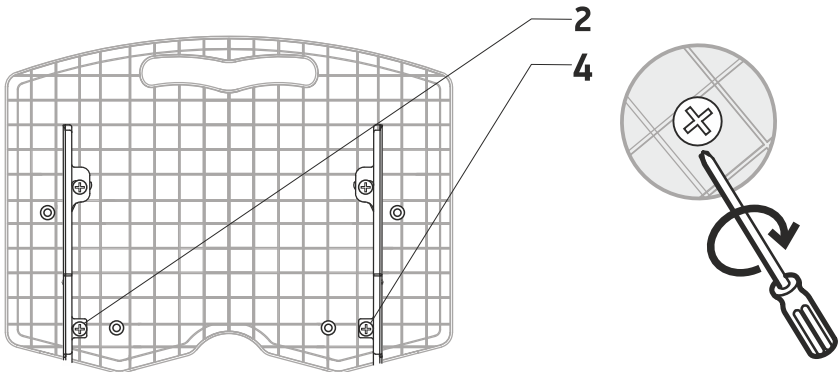

9. Cable management:

- Lay cables of your equipment in the columns from top to bottom, as shown on the picture.

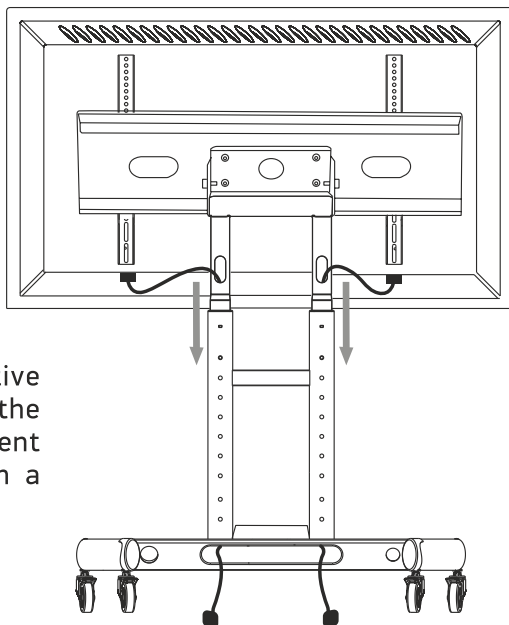

- Put cables through protective rings before connecting the touch panel / TV. They prevent cables from scratching on a sharp edge of the columns.

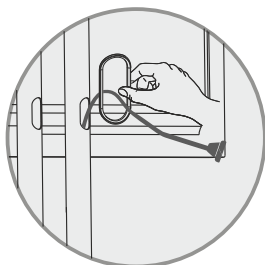

- Put protective rings into cable management holes in the columns.

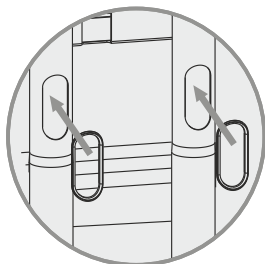

- Unlock the wheels and that is all.

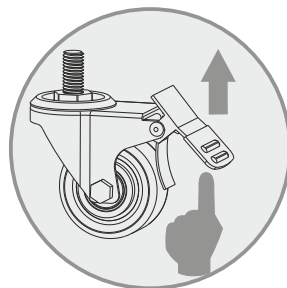

Content/Содержание:

	PAGE
Assembly kit.....	3
1. Base assembly.....	4
2. Height adjustment of the columns.....	4
3. Installation of the columns to the base.....	5
4. VESA-panel installation.....	6
5. Installation of the rails to the touch panel / TV.....	7
6. Possible VESA patterns and their sizes.....	8
7. Touch panel / TV mounting.....	9
8. Assembly and installation of the shelf.....	10
9. Cable management	12